

DIY Wine Room | (R-3.7, R-4.2, R-6.1)

Reflectix® Installation Instructions

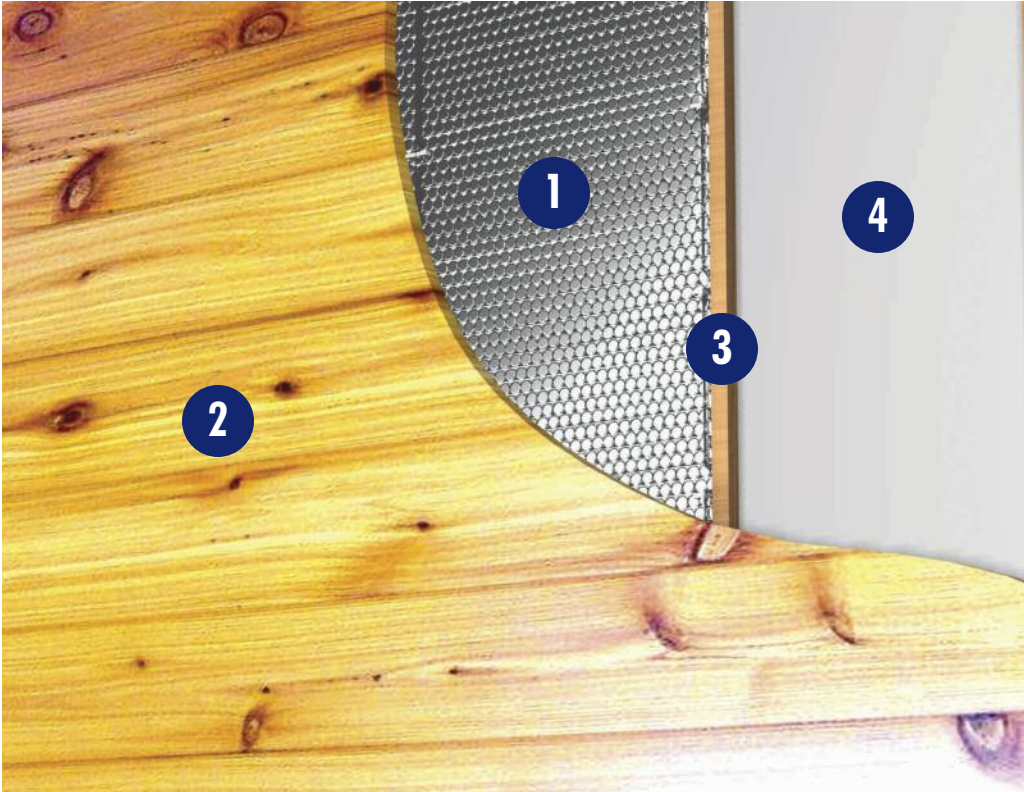

1. Reflectix® Insulation
2. Interior Panel
3. Furring Strip
4. Pre-existing Sheetrock

Tools Required:

Safety Glasses
Staple Gun
Tape Measure
Utility Knife/Scissors

Recommended Products:

Reflective/Bubble/Bubble/Reflective - Roll: BP24025 (24"x 25')

Staple Tab, Reflective/Bubble/Bubble/Reflective - Roll: ST16025 (16"x 25'), ST24025 (24"x 25')

Installation Instructions:

1. R-3.7 (1"x 2" furring with 1 air space)

- Attach 1"x 2" (nominal) furring strips vertically directly over the 2 x 4 studs (behind the sheetrock) on the wall.
- Cut the Reflectix® (with scissors or a utility knife) into lengths equal to the height of the wall (floor to ceiling).
- Staple the product to the face of the furring strip - product seams should split on a furring strip.
- One air space is created between the Reflectix® and the previously existing wall.
- Finish with interior panel (or sheetrock) of choice.

2. R-4.2 (2"x 2" furring with 1 air space)

- Same as above except utilize 2"x 2" (nominal) furring.

3. R-6.1 (2"x 2" furring with 2 air spaces)

- Attach 2"x 2" (nominal) furring strips vertically directly over the 2 x 4 studs (behind the sheetrock) on the wall.
- It is easiest to utilize the Staple Tab (16" or 24" depending on stud spacing) Reflectix® Reflective/Bubble product, although the standard edge product will also provide the same level of benefit.
- Cut the Reflectix® Insulation (with scissors or a utility knife) into lengths equal to the height of the wall (floor to ceiling).
- Staple the product to the side of the furring strip at a dept of 3/4" - the goal is to split the cavity (in two) into approximately equal air spaces.
- The two air spaces created are - one between the Reflectix® Insulation and the previously existing wall and the other between the new interior panel and the Reflectix® Insulation.
- Finish with interior panel (or sheetrock) of choice.

Review These Important Safety Guidelines Prior to Installation:

- **ALWAYS** check local building codes before installing Reflectix®.
- **ALWAYS** check the area you are insulating and make any needed repairs. Any worn wiring should be replaced before you begin installing Reflectix®.
- **ALWAYS** make sure work areas are well ventilated and well lighted.
- **ALWAYS** use eye protection when operating a staple gun.
- **ALWAYS** use caution and common sense when using a staple gun. Be aware of where electrical wiring is located. Stapling into a wire can cause severe shock or death. **NEVER** staple into electrical wiring.
- **ALWAYS** be careful when working with large pieces of Reflectix® on windy days.
- When installing Reflectix® on bright sunny days, it is best to wear sun glasses.
- Do not work in areas such as attics when temperatures are too hot.
- Visit our website at www.reflectixinc.com for additional product and installation information.

Please Note:

The intention of these Installation Instructions and 3-D renderings are for the sole purpose of illustrating the correct location and relative position of the Reflectix® products in specific building assemblies. The correct construction methods and techniques are the responsibility of the installer or contractor. The methods outlined are recommendations on location of the Reflectix® products as a guideline. There are no claims on the part of Reflectix, Inc. that these building assemblies are finite standards or meet building code requirements (as they can vary by region).

Reflectix, Inc.

#1 School Street (P.O. Box 108)

Markleville, IN 46056

Ph: (800) 879-3645 (US/Can)

(765) 533-4332

Fax: (765) 533-2327

Email: customerservice@reflectixinc.com

Web: www.reflectixinc.com

"Like Us" @: www.facebook.com/ReflectixInsulation

www.youtube.com/ReflectixInsulation

www.pinterest.com/reflectixinc

