

# Pro Knee Wall | (R-16, R-19)

## Reflectix® Installation Instructions

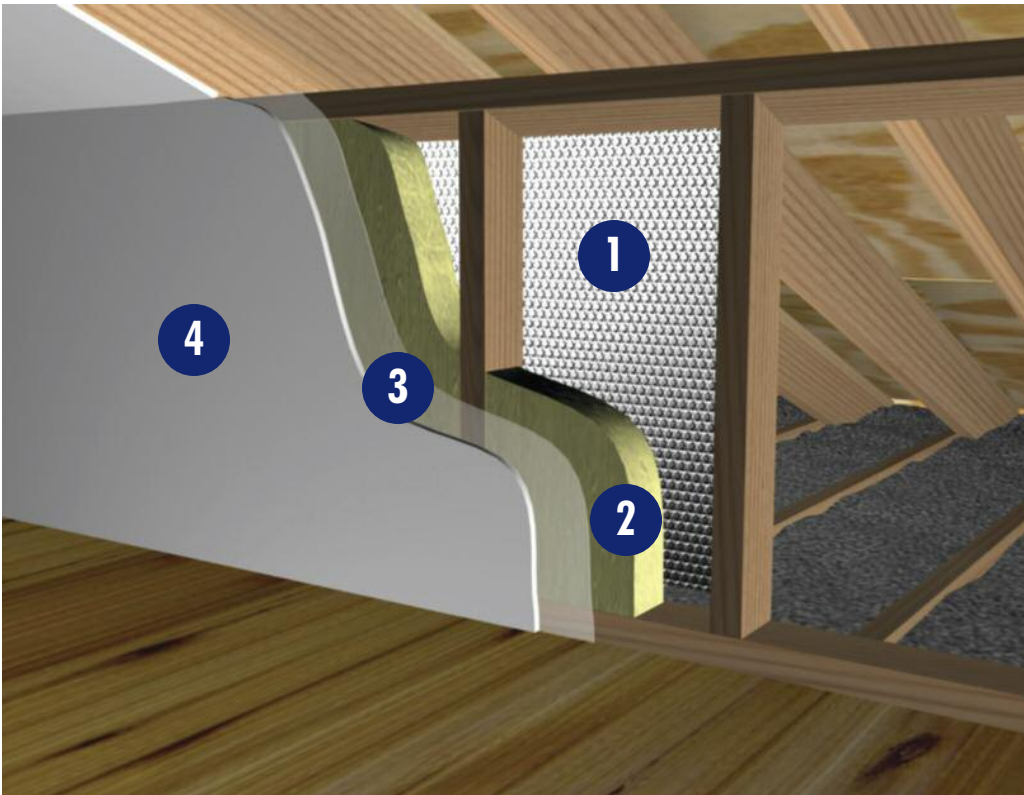

1. Reflectix® Insulation
2. R-13 Fiberglass Batt
3. Vapor Barrier (Polyethylene) if Code Required
4. Interior Panel (Sheetrock)

### Tools Required:

Safety Glasses

Staple Gun

Tape Measure

Utility Knife/Scissors

**Note:** Installation instructions and illustrated drawings are recommendations only, while proper local construction methods are the responsibility of the installer.

### Recommended Products:

Reflective/Bubble/Bubble/Reflective - Roll: BP24050 (24"x 50'), BP24100 (24"x 100')

Staple Tab, Reflective/Bubble/Bubble/Reflective - Roll: ST16050 (16"x 50'), ST16100 (16"x 100'), ST24050 (24"x 50'), ST24100 (24"x 100')

### Installation Instructions: (There are 2 methods with varying levels of benefit)

#### 1. Product Installed in the Back of the Knee Wall Cavity - R-16 and a Radiant Reflector (with R-13 Fiberglass Batt)

- Construct Knee Wall per Building Code.
- Prior to installing fiberglass batts, measure the inside height of the knee wall cavity.
- Precut the Reflectix® to this measured length minus 1/2".
- Start at the inside top of the first cavity.
- If utilizing the Reflective/Bubble/Bubble/Reflective, Staple Tab product, staple the tab of the product to the side of the stud and continue downward stapling every 3" to 4" - Repeat on opposite stud - The plane created by the product should be parallel to the back side faces of the studs - There should be a continuous 1/2" air gap across the bottom of the cavity.

- If utilizing the Reflective/Bubble/Bubble/Reflective product, staple the edge of the product to the back face of the stud, splitting the stud - Continue downward stapling every 3" to 4" - Repeat on opposite stud - The plane created by the product should be parallel to the back side faces of the studs - There should be a continuous 1/2" air gap across the bottom of the cavity.
- Install Fiberglass Batt per Manufacturer's Instructions.
- Install a Vapor Barrier on the inside of the Knee Wall if your Building Code dictates.
- Finish interior of Knee Wall.

## 2. Product Installed in the Back of the Knee Wall Cavity - R-19 and a Radiant Reflector (with R-13 Fiberglass Batt and 0.75" furring (on the back of the Knee Wall))

- Prior to placing the Knee Wall and nailing it to the floor and rafters, attach a 1"x 2" (nominal) furring strip to the back of each Knee Wall Stud.
- Install Reflectix® per instruction in Method #1 (above).

### Review These Important Safety Guidelines Prior to Installation:

- **ALWAYS** check local building codes before installing Reflectix®.
- **ALWAYS** check the area you are insulating and make any needed repairs. Any worn wiring should be replaced before you begin installing Reflectix®.
- **ALWAYS** make sure work areas are well ventilated and well lighted.
- **ALWAYS** use eye protection when operating a staple gun.
- **ALWAYS** use caution and common sense when using a staple gun. Be aware of where electrical wiring is located. Stapling into a wire can cause severe shock or death. **NEVER** staple into electrical wiring.
- **ALWAYS** be careful when working with large pieces of Reflectix® on windy days.
- When installing Reflectix® on bright sunny days, it is best to wear sun glasses.
- Do not work in areas such as attics when temperatures are too hot.
- Visit our website at [www.reflectixinc.com](http://www.reflectixinc.com) for additional product and installation information.

### Please Note:

The intention of these Installation Instructions and 3-D renderings are for the sole purpose of illustrating the correct location and relative position of the Reflectix® products in specific building assemblies. The correct construction methods and techniques are the responsibility of the installer or contractor. The methods outlined are recommendations on location of the Reflectix® products as a guideline. There are no claims on the part of Reflectix, Inc. that these building assemblies are finite standards or meet building code requirements (as they can vary by region).

### Reflectix, Inc.

#1 School Street (P.O. Box 108)

Markleville, IN 46056

Ph: (800) 879-3645 (US/Can)

(765) 533-4332

Fax: (765) 533-2327

Email: [customerservice@reflectixinc.com](mailto:customerservice@reflectixinc.com)

Web: [www.reflectixinc.com](http://www.reflectixinc.com)

"Like Us" @: [www.facebook.com/ReflectixInsulation](https://www.facebook.com/ReflectixInsulation)

[www.youtube.com/ReflectixInsulation](https://www.youtube.com/ReflectixInsulation)

[www.pinterest.com/reflectixinc](https://www.pinterest.com/reflectixinc)

